

# COTTER PIN

DIN 94

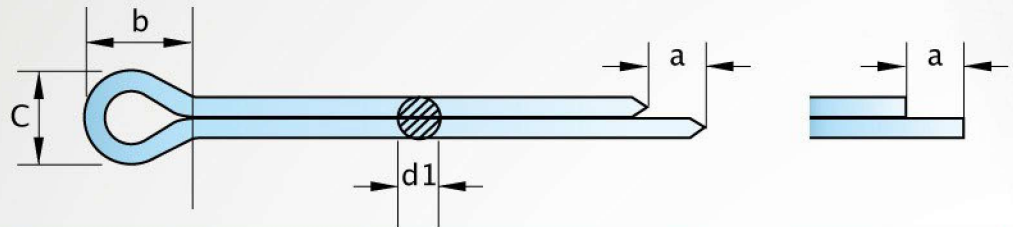

Nominal Dia		M1.6	M2	M2.5	M3.2	M4	M5	M6.3	M8	M10	M13	M16
d1	max	1.4	1.8	2.3	2.9	3.7	4.6	5.9	7.5	9.5	12.4	15.4
	min	1.3	1.7	2.1	2.7	3.5	4.4	5.7	7.3	9.3	12.1	15.1
a	max	2.5	2.5	2.5	3.2	4	4	4	4	6.3	6.3	6.3
	min	1.25	1.25	1.25	1.6	2	2	2	2	3.2	3.2	3.2
b	ref.	3.2	4	5	6.4	8	10	12.6	16	20	26	32
c	max	2.4	3.2	4	5.1	6.5	8	10.3	13.1	16.6	21.7	27
	min	2.8	3.6	4.6	5.8	7.4	9.2	11.8	15	19	24.8	30.8
Length		Nominal Dimension										
Basic	Tol.											
8	-0.75											
10	+0.75											
12												
14	-0.9											
16	+0.9											
18												
20												
22	-1.0											
25	+1.0											
28												
32												
36												
40	-1.25											
45	+1.25											
50												
56												
63	-1.5											
71	+1.5											
80												
90												
100	-1.75											
112	+1.75											
125												
140	-2.0											
160	+2.0											
180												
200												
224	-2.3											
250	+2.3											